

# STORGARD® II

## Assembly Instructions



1. Hold trap at top with one hand, and grasp bottom with other hand and pull apart.
2. Tuck side panels inward along creases.
3. Remove STORGARD® slow release lure (cap) from laminated foil package and place directly on the sticky surface by dropping it through the side opening and onto the center of the trap.

Transfer lure to replacement trap, should trap need changing before the suggested lure termination date.

**IMPORTANT: USE ONLY ONE LURE PER TRAP**

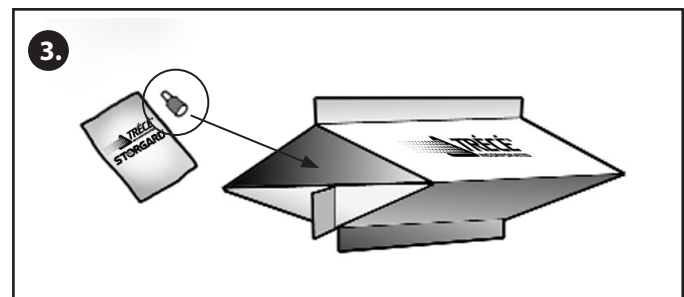
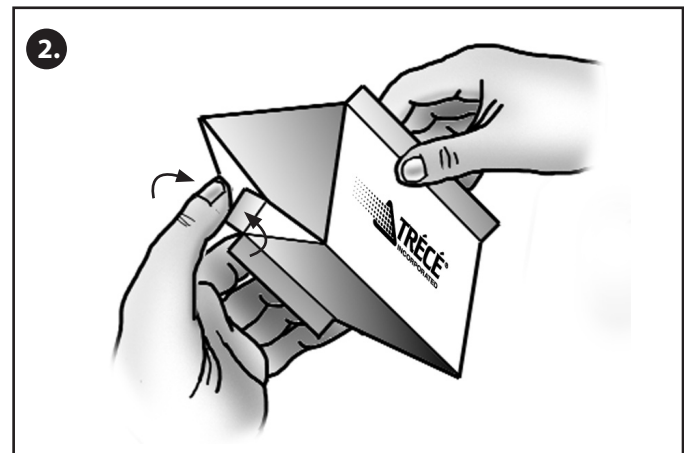
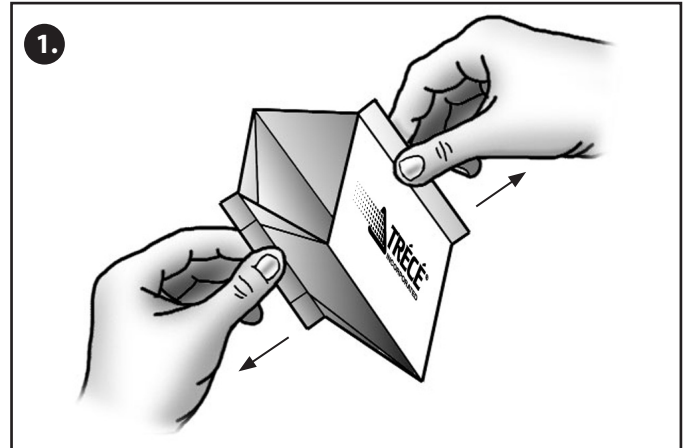

Please see Tréce's IPM Partner® Guidelines for further instructions.

Visit our website: [www.trece.com](http://www.trece.com) or call 1-866-785-1313

© 2010 TRECE, Adair, OK USA  
TRECE, PHEROCON, STORGARD and CIDETRAK are registered trademarks of Tréce, Inc., Adair, OK USA



INSECT PHEROMONE & KAIROMONE SYSTEMS

*Your Edge – And Ours – Is Knowledge.*